

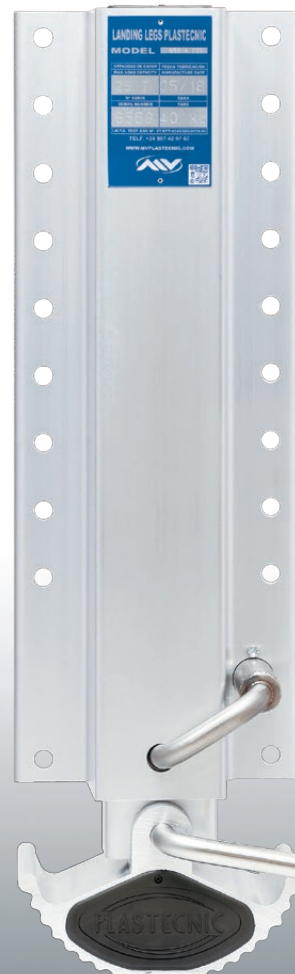

PLASTECHNIC®

Simple solutions, for strong reasons



PLASTECHNIC® has been manufacturing our high-quality aluminium landing leg since 1999. It is designed for vehicles with pneumatic suspension and its purpose is to offer our clients the possibility to minimize the tare of their semitrailer and therefore maximise the useful load.

MEASURES IN mm

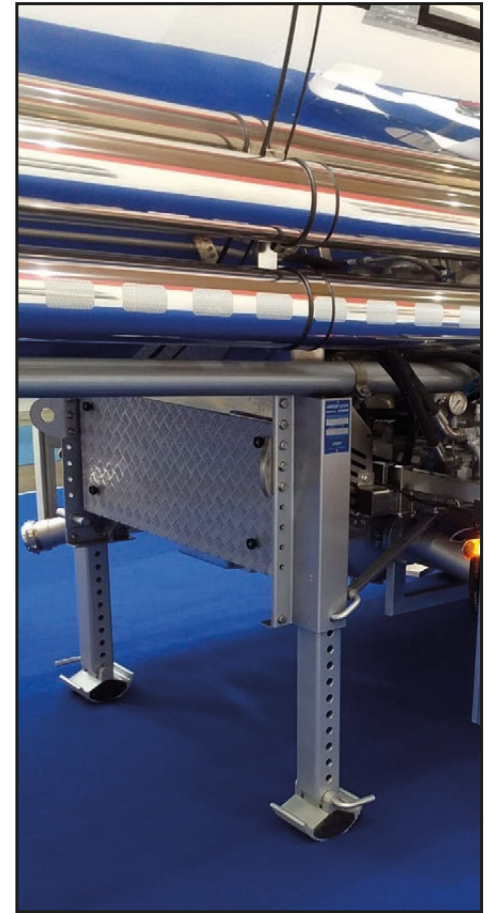
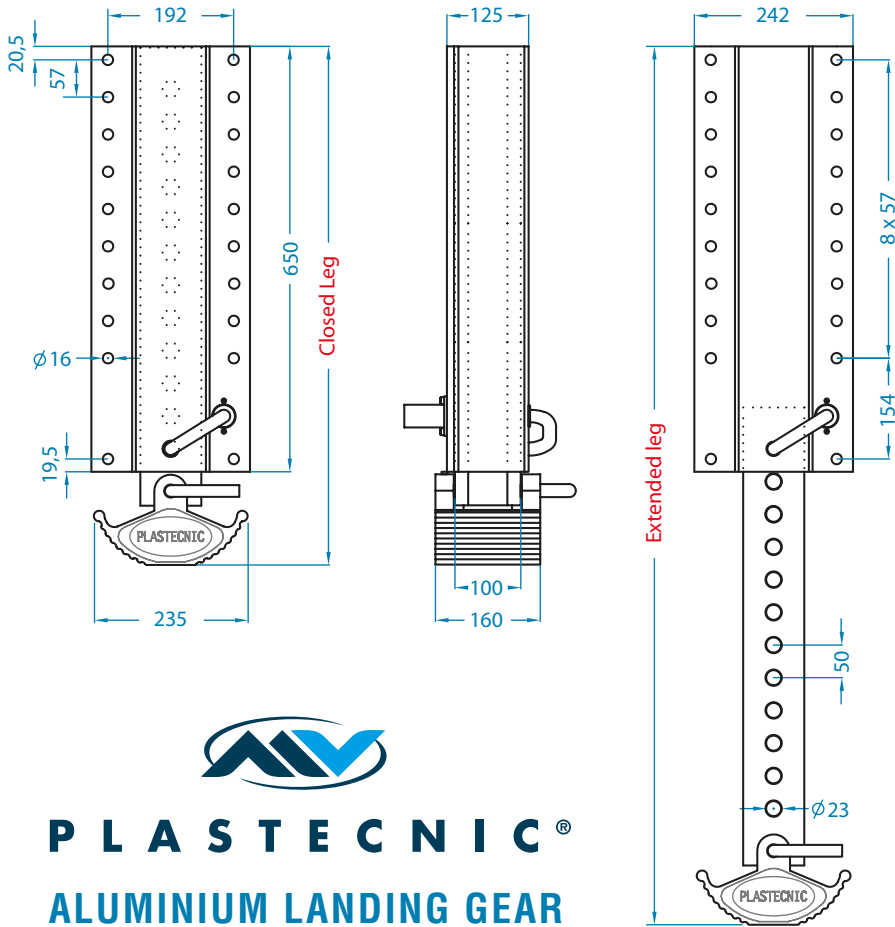



PLASTECNIC®
ALUMINIUM LANDING GEAR

Strength, durability and weight reduction are the key features of PLASTECNIC® R&D department continued efforts. To produce strong & light weight aluminium landing gear, that assists semitrailer manufacturers to reach their goals minimising tare, increasing their useful load capacity.

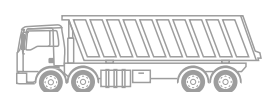
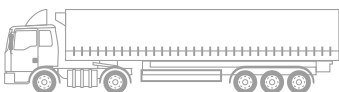
SPECIFICATIONS					
Model	Closed leg	Extended leg	Distance between holes	Maximum Load per set	Weight per set
650 x 700	795 mm.	1295 mm.	50 mm.	25.000 Kg.	40 Kg.
650 x 880	972 mm.	1445 mm.	50 mm.	25.000 Kg.	43 Kg.
650 x 980	1073 mm.	1545 mm.	50 mm.	25.000 Kg.	45 Kg.

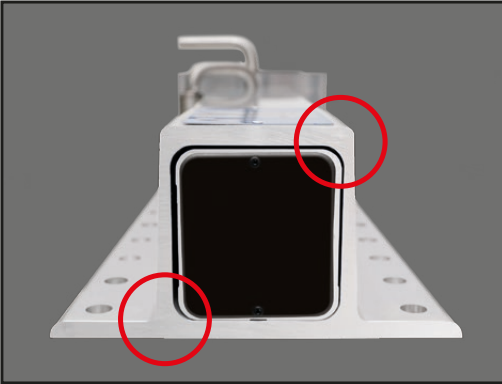

FEATURES



Specifications and design.

Our landing legs are produced from three quality grade aluminium extruded profiles of 6082 alloy followed by a T6 treatment.

The landing leg is engineered with a locking device made entirely of stainless steel 304.

The design is made with reinforcement in the most crucial zones, this allows for higher resistance to vertical loads, up to 25 tons per pair. The edges of the unit are engineered to be blunt for safety and ease of access.

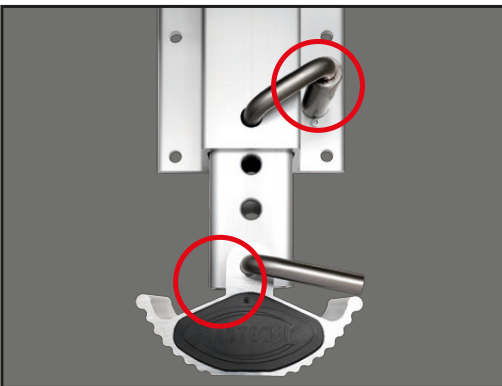

Handling and safety.

The locking mechanism is based on a spring compressed pin, this frees the user from the task of extending the foot by a hand crank.

This process is designed utilising the pneumatic suspension in conjunction with the landing leg, making it quick and effortless.

The oscillating foot allows for all types of longitudinal movements that could occur. The foot is engineered to maintain its function without fail even if there is a loss of pressure in the pneumatic suspension or any movements that may take place during coupling manoeuvres.



- MADE OF ALUMINIUM AND STAINLESS STEEL
- MAX. LOAD OF 25 TONS PER PAIR
- REDUCE TARE BY UP TO 100 KG.
- FOR VEHICLES WITH AIR SUSPENSION
- EASY INSTALLATION AND HANDLING
- UNIVERSAL DISTANCE BETWEEN HOLES
- NO MAINTENANCE REQUIRED
- FOR STEEL AND ALUMINIUM CHASSIS
- SUPPORT ON ANY SURFACE
- SPRING LOADED LOCKING PIN
- OSCILLATING BASE FOR IMPROVED STABILITY
- CUSTOMIZED LENGTH MODELS
- GUARANTEED FOR TWO YEARS



PLASTECNIC®

Polígono Industrial Bierzo Alto
A-6 Km. 372 / Parc. IA - 4 / 24318
San Román de Bembibre. León. España
Tfn. +34 987 429 767 Fax. +34 987 429 719

info@mvplastecnic.com
www.mvplastecnic.com



ISO 9001:2015 TÜV Rheinland
nº reg. 01100028004



TEST:
ST/RPT/7470/006/INTA/18(I)